

SITE PLAN AT PREMISES NO. - 024, ROY BAHADUR ROAD, WARD NO. - 117, BOROUGH - XIII
UNDER K. M.C., P.O. & P.S. - BEHALA

SCALE - 1:200

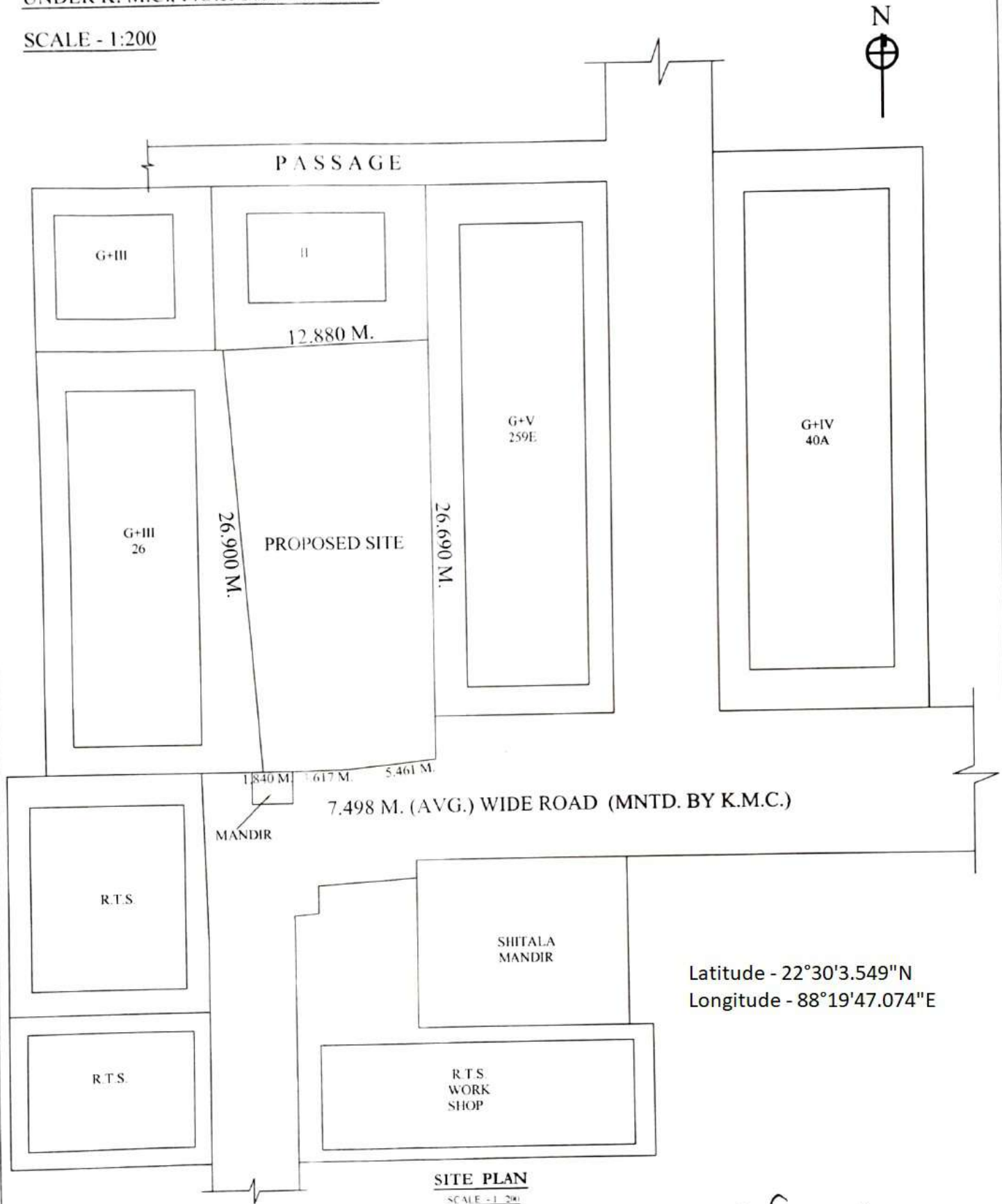

Latitude - 22°30'3.549"N
Longitude - 88°19'47.074"E

SITE PLAN
SCALE - 1:200

FOR SRI DEVELOPERS

Jagan Prasad
PARTNER

SIGNATURE OF OWNER

FOR SRI DEVELOPERS

Ranbir Kumar Sah

PARTNER

Krishnendu Ray

KRISHNENDU RAY
LBS OF K.M.C.
LBS No.: 1085, CLASS-1

SIGNATURE OF L.B.S.

LOCATION PLAN AT PREMISES NO. - 024, ROY BAHADUR ROAD,
WARD NO. - 117, BOROUGH - XIII UNDER K. M.C., P.O.& P.S. - BEHALA

SCALE - 1:4000

Latitude - 22°30'3.549"N
Longitude - 88°19'47.074"E

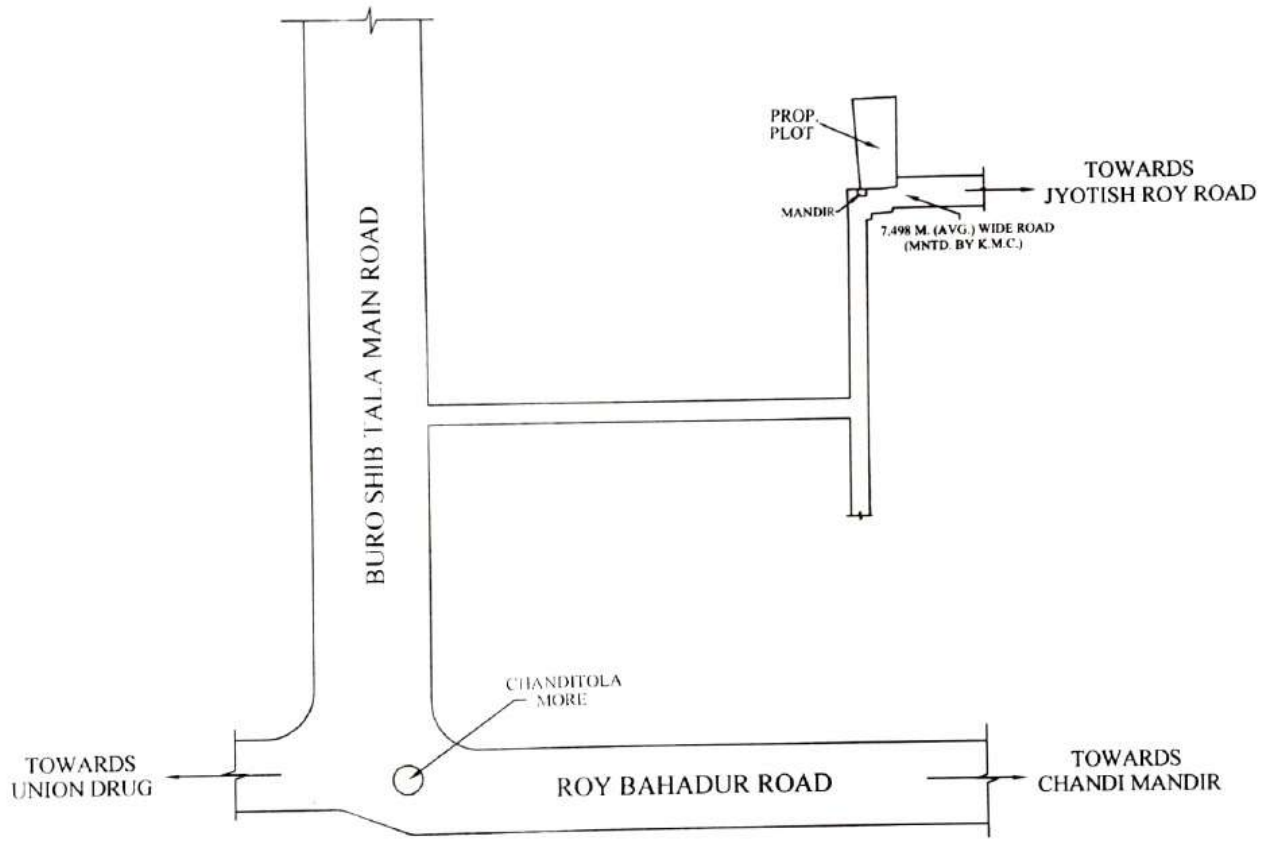

KEY PLAN
SCALE - 1 : 4000

FOR SRI DEVELOPERS
[Signature]
PARTNER

FOR SRI DEVELOPERS
Ranbir Kumar Sat
PARTNER

[Signature]
KRISHNENDU RAY
LBS OF K.M.C.
LBS No.: 1085, CLASS-1
SIGNATURE OF L.B.S.

SIGNATURE OF OWNER